

We Can Replace Your Dreams With Reality!



10197 US 127  
Clarklake MI 49234

(517)206-2435

LegendaryHomesInc.com

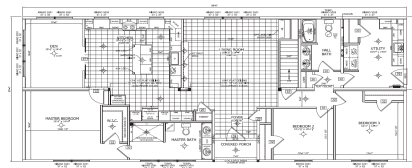

2,040 Sq Ft

01/01/25

**New Era Catalina – Edge Series (Similar to Our Redman Winston Model)**  
**Options Done on 2024 Napa Valley Fall Show Home Modular Home 30' x 68' Ranch**  
**Options as done on model home with 9' Insulated Precast Basement**

<b>Base price of New Era Catalina</b>	<b>\$182,970</b>
<b>Includes Finished Roll Set on foundation, Drywall finish, Side Ends, Seem Carpet Includes Sales Tax and Freight within 30 Miles of Our Model Home</b>	
Allowance for Price Increases/Adjustments Until 30 Days Before Home Goes Online (Cost will be adjusted at that time) ???	\$3,000
Bracing of Insulated Precast Basement for Setting Home – (If Crane is needed add cost of crane)	\$2,200
Lumber Surcharge	\$27,296
Modular Seals and State Dues on Modular Home	\$396
*Finish Drop Down Eaves and Siding Below Them	\$800
Clay Package	\$1,105
Jade Interior Package	\$2,500
Black Interior Finish Package	\$470
Painted Cabinet Package	\$2,106
NEV780 Dormer	\$2,150
*Set Up Cost to Build Dormer	\$2,500
7/16" OSB Sheathing	\$1,188
Siding Upgrade – Chamclad 6" - Cinnamon Walnut	\$1,755
Installed Black, Vertical LP Siding	\$1,610
Tempered Kinro 3036 (4 x \$56)	\$224
Clay Painted Ext Door (2 x \$345)	\$690
Cortec Pro Plus – Belmont Hickory Floor Covering – Den	\$670
Cortec Pro Plus – Belmont Hickory Floor Covering – Hall – Ship Loose	\$168
*Install Cortec Pro Plus Flooring On Site – Hall and Part of Kitchen	\$3,000
Cabinet 36BC4 in Living Room – White 48"	\$555
Colonial Trim Upgrade	\$250
White Door Panel Box Cover	\$220
Stainless Steel Smoothtop Electric Range	Inc
21 CF Stainless Steel Side X Side Refrigerator	Inc
3 Cycle Dishwasher	Inc
Stainless Steel Microwave	Inc
Hall Bath Backsplash – Schluter Schiene Tilebar AE 125 (6')	\$22
Utility Room Backsplash – Schluter Schiene Tilebar AE125 (12.5')	\$45
Recessed LED Lights (8 x 28)	\$224
Ceiling Fan – Model Panasonic BTH Fan FV-0511VKS2 *2 x \$190)	\$380
*Installation for Fans (2)	\$100
Programmable Thermostat	\$99
Recept and Recessed Dryer Vent	\$242
Install Ductwork	\$1,687
Electric Furnace	\$1,260
50 Gallon Electric Water Heater	\$850
Furnace A/C Coil Box	\$182
Washer Plumbing	\$217
Ship Loose Flooring – Cinnamon Walnut	\$450
*Installation of Screens T/O	\$75
Cold Air Return Grills (8)	\$504
Blocking for Home for Insulated Precast Foundation	\$750
Michigan State Approval	\$905
3 <sup>rd</sup> Party Seals/MI	\$290
Allowance for Future Drywall Repair for Drywall Settling to come back in a year after home is set	\$1,000
<b>Subtotal of Options</b>	<b>\$64,135</b>
Sales Tax on Options	\$3,848
<b>Total House and Options</b>	<b>\$250,953</b>
( Cost Per Square Foot: \$123.02 )	
* Additional On Site Costs with Option Chosen	

