

30x60 RANCH  
1787 SQ. FT.

\* FURNACE OPTION INCLUDES WARM AIR DUCTS IN THE FLOOR AND RETURN AIR DUCTS IN THE CEILING

\* DESIGNATES FIELD WORK



308 SHERIDAN DRIVE TOPEKA, IN 46571

APPROVER'S SEAL

| MODIFICATIONS |                           |             |
|---------------|---------------------------|-------------|
| 4             | REMOVED MULLED WINDOWS    | -- 08-14-14 |
| 5             | REMOVED 6" WALL IN M BATH | -- 08-14-14 |
| 6             | ADDED CAN LIGHTS          | -- 08-18-14 |
| 7             | 2015 UPDATES              | -- 11-03-14 |

PROPRIETARY AND CONFIDENTIAL  
THESE DRAWINGS AND SPECIFICATIONS ARE ORIGINAL,  
PROPRIETARY AND CONFIDENTIAL MATERIALS OF CHAMPION.  
COPYRIGHT © 1976-2008 BY CHAMPION

|   |                        |
|---|------------------------|
| MODEL: <b>RM 1025</b><br>3060 3BR 2BATH - RANCH | SHEET:<br><b>L-101</b> |
| TITLE:<br><b>LITERATURE PLAN</b>                |                        |
| DRAWN BY: B. CampBell                           | DATE: 09-12-08         |
| SCALE: 1/8" = 1'-0"                             | Page: 10 of 47         |

REV. G

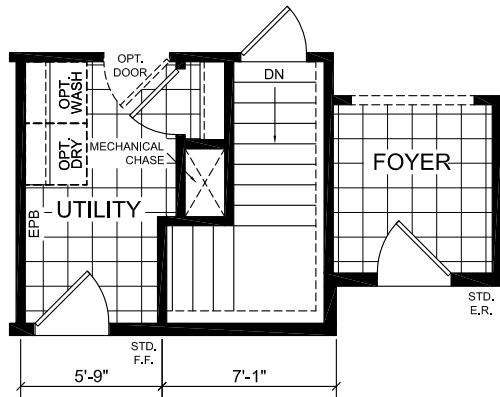

**OPTIONAL STAIRWELL**

\* (FURNACE, W/H & WARM AIR DUCTS ON-SITE BY OTHERS)

\* FURNACE OPTION N/A WITH BASEMENT OPTION

\* DESIGNATES FIELD WORK



308 SHERIDAN DRIVE TOPEKA, IN 46571

APPROVER'S SEAL

MODIFICATIONS

|   |                           |    |          |
|---|---------------------------|----|----------|
| 1 | MADE FURNACE OPTIONAL     | BC | 10-24-08 |
| 2 | REV. STAIRWELL SIZE & DIM | BC | 03-03-09 |
| 3 | REMOVED MULLED WINDOWS    | -- | 08-14-14 |
| 5 | REMOVED SEW/ALL IN M BATH | -- | 08-08-14 |

PROPRIETARY AND CONFIDENTIAL  
 THESE DRAWINGS AND SPECIFICATIONS ARE ORIGINAL,  
 PROPRIETARY AND CONFIDENTIAL MATERIALS OF CHAMPION,  
 COPYRIGHT © 1976-2008 BY CHAMPION

MODEL: **RM 1025**  
 3060 3BR 2BATH - RANCH

TITLE: **LITERATURE PLAN-OPT.**

DRAWN BY: B. CampBell

DATE: 09-12-08

SCALE: 1/8" = 1'-0"

Page: 11 of 47

SHEET:

**L-102**

**REV. E**